

# Pressure Regulator

## airvision modular

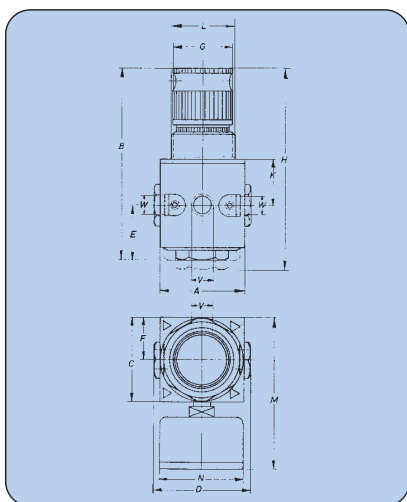

Compressed air pressure regulators in modular design maintain constant working pressure regardless of pressure fluctuations in the system or of air consumption. Flanging is possible on both sides for adding other airvision equipment. Port sizes G 1/8 to G 1. Secondary air exhaust (relieving) and almost complete independence of primary pressure. Diaphragm regulator with working pressure ranges 0,5 to 6, 10 and 16bar. Adjustment can be locked by pressing the handwheel. Gauge can be mounted on back or front.

**Important:** Use of filter always recommended.

### Technical Data

	I	II	III
Nominal rates of flow***	670NI/min	2080NI/min	2670NI/min
Max. inlet pressure (p <sub>1</sub> )		25 bar (PN25)	
Operating temperature		+50 °C	
Outlet pressure range (p <sub>2</sub> )	0,5 to 10bar - optionally: 6 and 16bar		
Mounting position	any		
Direction of flow	arrow		
Nominal width	DN6	DN15	DN20
Depend. upon supply pressure	<4%	<3%	<3%
Reversing control hysteresis	~1 bar		
Weight	300g	780g	1000g
Material			
Diaphragm/Seals		NBR	
Housing	zinc alloy	zinc alloy	aluminum

\*\*\* measured at p<sub>1</sub>=8bar, p<sub>2</sub>=6bar and Δp=1 bar

### Pressure Regulators

Size	G 1/8	G 1/4	G 3/8	G 1/2	G 3/4	G 1
I	444.213*	444.223	-	-	-	-
II	-	-	444.253*	444.263	-	-
III	-	-	-	-	7444.283*	7444.293

### special option - how to order:

x444.xxx		
2	- 0,5 - 6bar	operating pressure range
3	- 0,5 - 10bar	
4	- 0,5 - 16bar	
	- thread (1=G 1/8, 2=G 1/4, 5=G 3/8, 6=G 1/2, 8=G 3/4, 9=G 1)	
2	- with pressure gauge	
4	- without pressure gauge	
7	- Size III	

### Dimensions [mm]

BG	I G 1/8*, G 1/4	II G 3/8*, G 1/2	III G 3/4*, G 1
A	40	62	70
B	90	130	145
C	40	62	70
D	46 40	70 62	82 70
E	25	34	50
F	20	31	35
H	105	160	175
K	22	34	40
L	M30x1,5	M42x1,5	M42x1,5
M	75	100	107

### Rates of flow

p<sub>1</sub>=p<sub>2</sub>+2bar

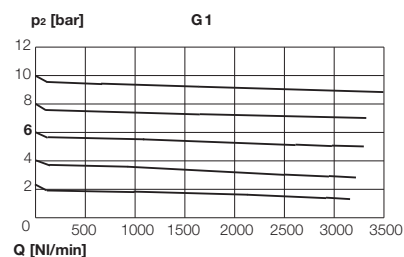
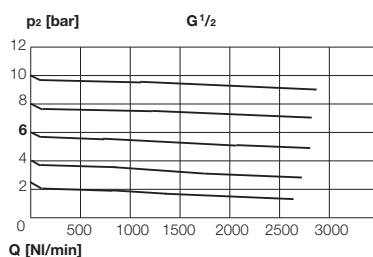
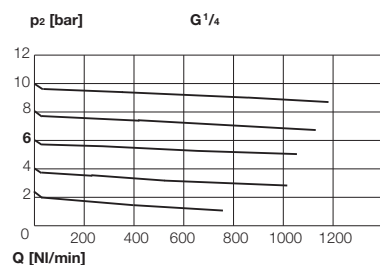

### Accessories

	I	II	III
Bracket mounting (for housing)	444-5	444-14	444-14
Bracket mounting (for top)			
Kit (bracket and nut)	443-36	443-104	443-104
Panel mounting (nut)	381-32	443-106	443-106

### Main spare parts

	I	II	III
Pressure gauge	Ø40 (G 1/8)	Ø50 (G 1/4)	Ø50 (G 1/4)
0 - 6/10bar	670	55	55
0 - 10/16bar	680	85	85
0 - 16/25bar	690	96	96
Valve complete with stem	443-142	444-17**	444-29**
Diaphragm complete with gliding ring	480-92	480-263**	480-263**

\*\* Before date of production "S4" valve and diaphragm must be ordered together